English Country Home for Sale

Nestled Between Two Private Lakes in Bloomfield Hills, Michigan



- | | | |
|--------------------------------------|---|---|
| ❖ 200 Ft. Waterfront on Island Lake | ❖ 200 Ft. Waterfront on Lower Long Lake | ❖ Private Setting abuts "Kirk in the Hills" |
| ❖ 2 + Acre Lot | ❖ 4 Bedrooms - 2 with Vaulted Ceilings | ❖ 5.5 Tiled Bathrooms |
| ❖ 13 Rooms- 2 Fireplaces | ❖ 2 Three Season Porches with Southern Exposure | ❖ 3 Car Heated Garage |
| ❖ 4,500 Finished Sq. Ft. | ❖ Sunrise Lit Kitchen & Breakfast Rooms | ❖ Au Pair Quarters |
| ❖ Bloomfield Hills Schools | ❖ Full Attic w Storage Rm. | ❖ Spectacular Sunsets & Westerly Breezes |
| ❖ Reclaimed Brick & Cypress Exterior | | ❖ Excellent Fishing, Kayaking & Sailing |
| ❖ Built in 1954 | | |

Price on Request - Contact info@1341kirkway.com



UPPER LEVEL = 2952 SQ. FT.
 LOWER LEVEL = 1547 SQ. FT.
 TOTAL = 4499 SQ. FT.

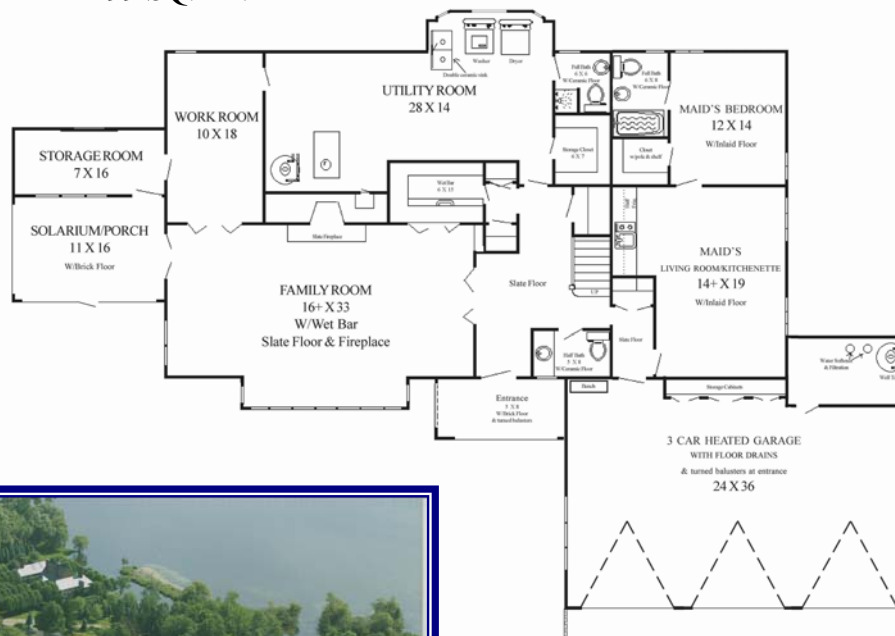

Offered By:

